

FASTENER DATA

TOOL CHARACTERISTICS

HEIGHT	WIDTH	LENGTH	WEIGHT
309 mm.	90 mm.	332 mm.	2.650 Kg.
MIN-MAX WORKING PRESSURE		70 / 120 PSIG 5 / 8 BAR	
AIR CONSUMPTION PER SHOT		PERFORMANCES AT 90 psi (0.62 Mpa) 1.17 l.	
LUBRICANT		BCNZ617 500 ml.	

AxB) SHANK	2.5 x 2.5 mm.
C) HEAD	7.00 mm.
L) LENGTH	25 mm.
MAGAZINE CAPACITY	85 Nails

* ACTUATION SYSTEM	3 (SAFETY : SS/CT)
--------------------	---------------------------

* LOADING	<input type="checkbox"/> BOTTOM LOADING <input checked="" type="checkbox"/> SIDE LOADING <input type="checkbox"/> TOP LOADING <input type="checkbox"/> COIL <input type="checkbox"/> OTHER
-----------	--------------------------------------------------------------------------------------------------------------------------------------------------------------------------------------------------------

* SEE INSTRUCTION MANUAL

NOISE CHARACTERISTICS	EN 12549+A1:2008	$L_{WA,1s}$, :95.67 dB(A) - $K_{WA,1s}$, 2.5
	EN ISO 4871:2009	$L_{pA,1s}$, :87.70 dB(A) - $K_{pA,1s}$, 2.5

VIBRATION VALUE	UNI ISO/TS 8662-11	m/s² 4.89
-----------------	-----------------------	-----------------------------

ESP	MACHINE CODE
8	21157
DESC.	R45C NT-25
CPL.BODY	138502
CPL.CAP.	140166.1

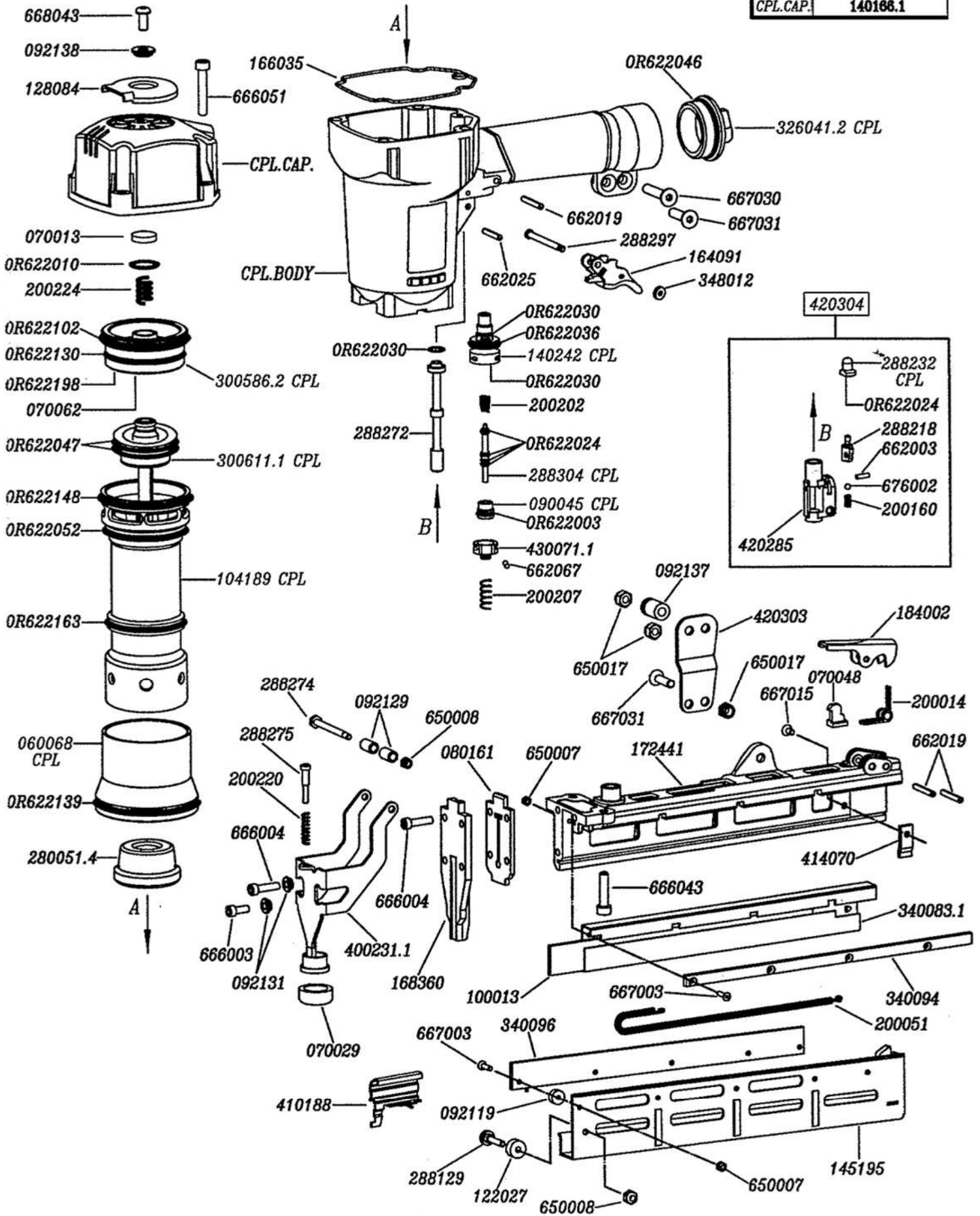

R45C NT-25

SPARE PARTS LIST

Code	RSP	Qty	Description	Code	RSP	Qty	Description
000060068		1	RING	000622046	R	1	O-RING
000070013	R	1	BUFFER	000622047	R	2	O-RING
000070029	R	1	BUFFER	000622052	R	1	O-RING
000070048	R	1	BUFFER	000622102	R	1	O-RING
000070062	R	1	BUFFER	000622130	R	1	O-RING
000080161		1	REST	000622139	R	1	O-RING
000090045		1	BUSH	000622148	R	1	O-RING
000092119		5	BUSH	000622163	R	1	O-RING
000092129		2	BUSH	000622198	R	1	O-RING
000092131		2	BUSH	000650007	R	9	NUT
000092137		1	BUSH	000650008	R	2	NUT
000092138		1	BUSH	000650017	R	4	NUT
000100013		1	MAGNET	000662003	R	1	PIN
000104189		1	CYLINDER	000662019	R	3	PIN
000122027		1	PULLEY	000662025	R	1	PIN
000128084		1	COVER	000662067	R	2	PIN
000138502		1	BODY	000666003	R	1	SCREW
000140166.1		1	CAP	000666004	R	3	SCREW
000140242		1	REMOTE CONTROL	000666043	R	2	SCREW
000145195		1	SLIDER	000666051	R	4	SCREW
000164091		1	TRIGGER	000667003	R	9	SCREW
000166035	R	1	GASKET	000667015	R	1	SCREW
000168360		1	PLATE	000667030	R	1	SCREW
000172441		1	LOADER	000667031	R	2	SCREW
000184002		1	CATCH	000668043	R	1	SCREW
000200014	R	1	SPRING	000676002		1	BALL
000200051	R	1	SPRING				
000200160	R	1	SPRING				
000200202	R	1	SPRING				
000200207	R	1	SPRING				
000200220	R	1	SPRING				
000200224	R	1	SPRING				
000280051.4	R	1	BUMPER				
000288129		1	PIN				
000288218		1	PIN				
000288232		1	PIN				
000288272		1	PIN				
000288274		1	PIN				
000288275		1	PIN				
000288297		1	PIN				
000288304		1	STUD				
000300586.2		1	PISTON				
000300611.1	R	1	DRIVER PISTON				
000326041.2		1	ADAPTER				
000340083.1		1	INSERT				
000340094		1	INSERT				
000340096		1	INSERT				
000348012		1	SPACER				
000400231.1	R	1	SAFETY				
000410188	R	1	PUSHER				
000414070		1	SQUARE				
000420285		1	ACTUATOR				
000420303		1	HOLDER				
000420304		1	ACTUATOR				
000430071.1		1	COVER				
000622003	R	1	O-RING				
000622010	R	1	O-RING				
000622024	R	5	O-RING				
000622030	R	3	O-RING				
000622036	R	1	O-RING				

R=Recommended spare parts